

SUBJECT: AUTHORIZATION TO ADVERTISE FOR BIDS – ISLAND ANNEXATION SEWER PROJECT (AREA 455A)

SOURCE: Public Works Department - Engineering Division

COMMENT: The City's consultant, Roberts Engineering, has completed the preparation of construction plans and specifications (i.e. Project Manual) for the Island Annexation Sewer Project - Area 455A. The proposed project will be the second 2006 island annexation area to receive new sewer infrastructure. Area 455A is generally bounded by the W. North Grand Avenue to the north, Mulberry Avenue to the south, Beverly Street to the west and State Highway 65 to the east. In total there are five (5) areas slated for new sewer infrastructure with the first, Area 458A & 458B currently under construction. For the benefit and convenience of the public, each area will be constructed sequentially.

The proposed project includes 10,035 lineal feet (1.9 miles) of 8" and 6" diameter sewer mains, 29 sewer manholes and 216 sewer laterals. Construction sequencing will be essential throughout the project and specified as such, so as to maintain access and minimize the inconvenience within the neighborhoods affected by this project.

On May 30, 2013, staff will conduct a "community information meeting" with the residents of Area 455A. Staff will discuss the possibility of forming a sewer utility district and various sewer connection options as completed for Areas 458A & 458B.

The Plans and Project Manual have been completed and are available in the La Barca Conference Room for Council's review. The Engineer's estimate of probable cost for construction is \$1,052,181.00. An additional \$105,218.10 is necessary for construction contingency (10%). It is anticipated that an additional \$52,609.05 is required for construction management, quality control and inspection services (5%) for a total estimated project cost of \$1,210,008.15.

Refinancing of the Sewer Revenue Bonds, better known to staff as Certificate of Participation (COP) funds, is the mechanism for funding this project and subsequent project areas. The stated funding source was approved in the 2012/2013 Annual Budget.

Dir MB Appropriated/Funded MB CM J

Item No. 4

Once a contract has been awarded, staff will consider, if so offered, asphalt paving options similar to the trench repair option offered by the Area 458 Sewer Utility District Contractor. An important point that must be noted is that any option proposed by the Area 455 Contractor must be equal to or greater in value to the bid price offered by the Contractor to repair the sewer main and lateral trenches.

RECOMMENDATION: That City Council:

1. Approve Staff's recommended Plans and Project Manual; and
2. Authorize staff to advertise for bids on the project.

ATTACHMENTS: Locator Map
Engineer's Estimate

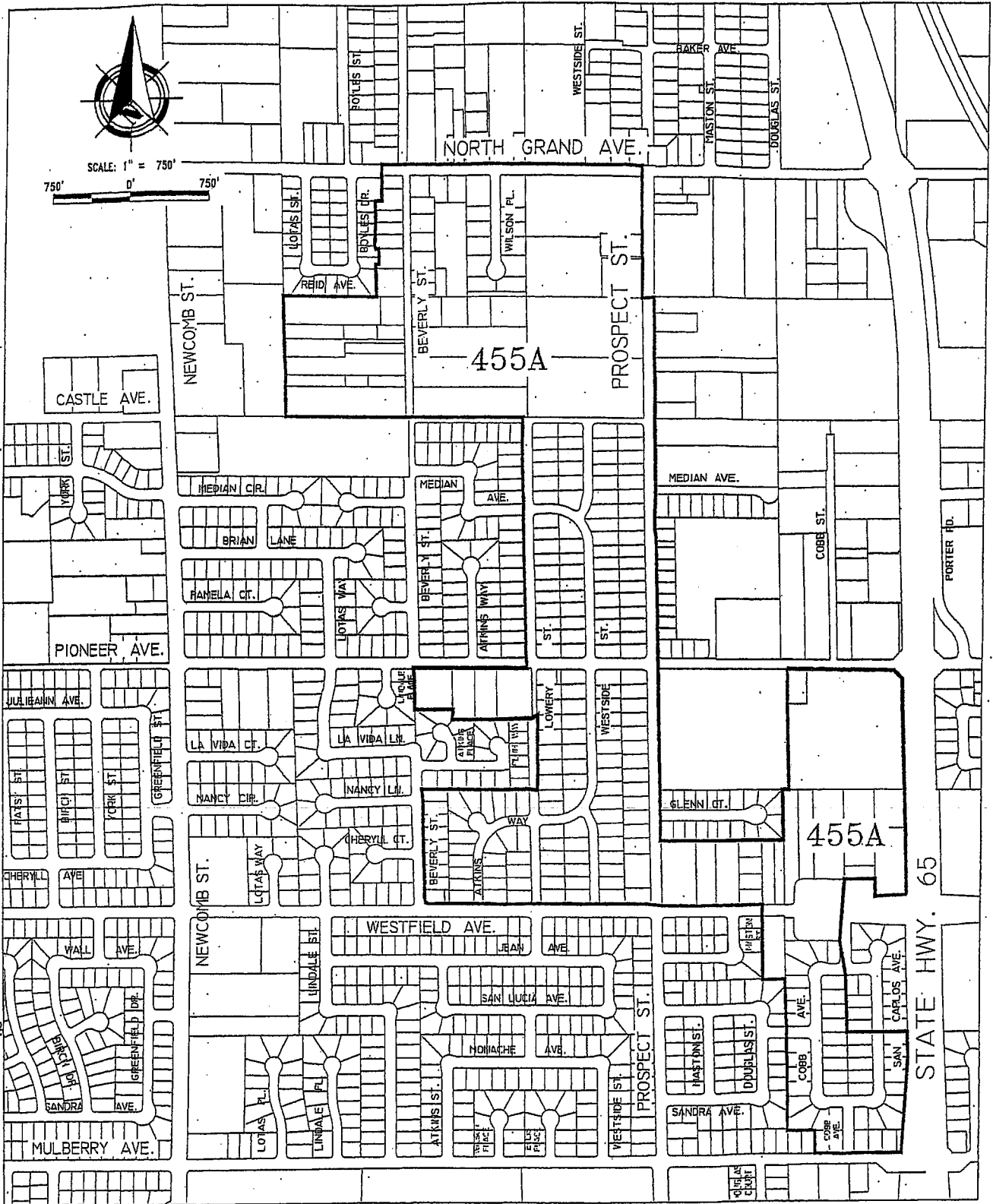

□ PROJECT BOUNDARIES

ISLAND ANNEX. 455A

Porterville Island Annexation 455A Sewer Project

Authorization to Bid

BASE BID

Item No.	Description	Quantity	Unit	Unit Price	Extension Price
1	Mobilization and Demobilization	1	L.S.	\$15,000.00	\$15,000.00
2	Sheeting and Shoring	1	L.S.	\$5,000.00	\$5,000.00
3	Traffic Control	1	L.S.	\$25,000.00	\$25,000.00
4	Notice of Intent to Discharge (NOID), Storm Water Pollution Prevention Plan (SWPPP), and Monitoring Plan (MP)	1	L.S.	\$5,000.00	\$5,000.00
5	Provide Dust Mitigation Plan as required and in conformance with state and federal regulations	1	L.S.	\$5,000.00	\$5,000.00
6	Provide Demolition, Clearing, and Grubbing as necessary	1	L.S.	\$5,000.00	\$5,000.00
7	Connect new 6-inch sewer piping to existing 6-inch sewer piping, including removal of existing cleanout, excavation, backfill, and compaction	4	EA.	\$500.00	\$2,000.00
8	Connect new 6-inch sewer piping to existing 6-inch sewer piping, including removal of existing manhole assembly, excavation, backfill, and compaction	1	EA.	\$1,000.00	\$1,000.00
9	Cut In and Connect new 6-inch sewer piping to existing manhole assembly, including excavation, backfill, and compaction	5	EA.	\$1,000.00	\$5,000.00
10	Cut In and Connect new 6-inch sewer piping to existing manhole assembly at Prospect Street Sta. 23+03.18, as shown on Sheet 20, Per City Standard S1.1, including modified interior drop manhole connection to existing 8-inch stub, excavation, backfill, and compaction	1	L.S.	\$1,500.00	\$1,500.00

11	Cut In and Connect new 8-inch sewer piping to existing manhole assembly at Prospect Street Sta. 22+98.61, as shown on Sheet 19, Per City Standard S1.1, including modified interior drop manhole connection to existing manhole assembly, excavation, backfill, and compaction	1	L.S.	\$1,500.00	\$1,500.00
12	Connect new 8-inch sewer piping to existing 8-inch sewer piping, including removal of existing cleanout, excavation, backfill, and compaction	1	EA.	\$500.00	\$500.00
13	Cut In and Connect new 8-inch sewer piping to existing manhole assembly, including excavation, backfill, and compaction	5	EA.	\$1,000.00	\$5,000.00
14	Connect new 8-inch Sewer Piping to existing 8-inch stub, including removal of existing plug, excavation, backfill, and compaction	3	EA.	\$750.00	\$2,250.00
15	6-inch Sewer Piping, including excavation, backfill, and compaction	3,856	L.F.	\$30.00	\$115,680.00
16	8-inch Sewer Piping, including excavation, backfill, and compaction	6,179	L.F.	\$40.00	\$247,160.00
17	48-inch Sanitary Sewer Manhole Assembly Per City Standard S-1 maximum height 5 feet, including excavation, backfill, and compaction	11	EA.	\$2,200.00	\$24,200.00
18	48-inch Sanitary Sewer Manhole Assembly Per City Standard S-1 maximum 7 feet, including excavation, backfill, and compaction	9	EA.	\$2,400.00	\$21,600.00
19	48-inch Sanitary Sewer Manhole Assembly Per City Standard S-1 maximum height 9 feet, including excavation, backfill, and compaction	4	EA.	\$2,600.00	\$10,400.00
20	48-inch Sanitary Sewer Manhole Assembly Per City Standard S-1 maximum height 11 feet, including excavation, backfill, and compaction	3	EA.	\$2,800.00	\$8,400.00

21	48-inch Storm Drain Manhole Assembly Per City Standard S-1, maximum height 10 feet, including excavation, backfill, and compaction	2	EA.	\$2,800.00	\$5,600.00
22	Provide 18-inch Storm Drain Pipe, including excavation, backfill, and compaction	12	L.F.	\$75.00	\$900.00
23	Remove existing storm drain manhole assembly and pipe as necessary	1	L.S,	\$1,400.00	\$1,400.00
24	Provide Sanitary Sewer Clean-Out Assembly Per City Standard S-11, including excavation, backfill, and compaction	15	EA.	\$1,500.00	\$22,500.00
25	4 inch Sewer Lateral, Wye, and End Plug Per City Standard S-7 from sewer piping to approximate property line, up to 20 foot length, including excavation, backfill, and compaction	52	EA.	\$450.00	\$23,400.00
26	4 inch Sewer Lateral, Wye, and End Plug Per City Standard S-7 from sewer piping to approximate property line, up to 30 foot length, including excavation, backfill, and compaction	54	EA.	\$600.00	\$32,400.00
27	4 inch Sewer Lateral, Wye, and End Plug Per City Standard S-7 from sewer piping to approximate property line, up to 40 foot length, including excavation, backfill, and compaction	60	EA.	\$750.00	\$45,000.00
28	4 inch Sewer Lateral, Wye, and End Plug Per City Standard S-7 from sewer piping to approximate property line, up to 50 foot length, including excavation, backfill, and compaction	8	EA.	\$900.00	\$7,200.00
29	4 inch Sewer Lateral Piping Per City Standard S-7 from existing wye to approximate property line, up to 31 foot length, including removing end plug, connection to existing wye, excavation, backfill, and compaction, and new end plug	5	EA.	\$600.00	\$3,000.00
30	4 inch Sewer Lateral Piping per City Standard S-7 from manhole assembly to approximate property line up to 40 foot length, including excavation, backfill, compaction, and end plug	8	EA.	\$750.00	\$6,000.00

31	4-inch Sewer Lateral DR-14 C-900 Piping crossing over water main	29	EA.	\$1,000.00	\$29,000.00
32	Provide 6-inch End Plugs	4	EA.	\$100.00	\$400.00
33	Provide 8-inch End Plugs	2	EA.	\$150.00	\$300.00
34	Remove and Replace portion of concrete cross gutter per City Standard C-7, Detail "A", including expansion joints at each end of replacement at Westside and Pioneer.	1	L.S.	\$1,500.00	\$1,500.00
35	Remove and Replace portion of concrete cross gutter per City Standard C-7, Detail "A", including expansion joints at each end of replacement at Atkins Way and Westfield.	1	L.S.	\$1,500.00	\$1,500.00
36	Remove and Replace full concrete cross gutter per City Standard C-7, at Cobb Street north of Mulberry Avenue	1	L.S.	\$2,750.00	\$2,750.00
37	Provide Trench Resurfacing for 4-inch sewer piping per City Standard P-4, including sawcutting, excavation, backfill, and compaction	4,230	L.F.	\$20.00	\$84,600.00
38	Provide Trench Resurfacing for 6-inch sewer piping per City Standard P-4, including sawcutting, excavation, backfill, and compaction	3,868	L.F.	\$22.00	\$85,096.00
39	Provide Trench Resurfacing for 8-inch sewer piping per City Standard P-4, including sawcutting, excavation, backfill, and compaction	6,199	L.F.	\$25.00	\$154,975.00
40	Provide Trench Resurfacing for 18-inch storm drain piping per City Standard P-4, including sawcutting, excavation, backfill, and compaction	22	L.F.	\$35.00	\$770.00
41	Provide Trench Resurfacing and shoulder restoration along Beverly Street	900	L.F.	\$35.00	\$31,500.00
42	Reset Street Monuments	5	Each	\$600.00	\$3,000.00

43	Reset Section Monument - Tie out monuments, horizontally and vertically, in advance of construction. Prepare corner records for City and County review prior to recording of Corner Records.	3	Each	\$900.00	\$2,700.00
44	All items not included in Items 1 through 43 above necessary to make this a complete and operable system in accordance with the Plans and Specifications	1	L.S.	\$500.00	\$500.00
TOTAL BASE BID					\$1,052,181.00
10% Construction Contingency					\$105,218.10
5% Construction Management & Quality Control					\$52,609.05
TOTAL BID					\$1,210,008.15



 Project Engineer

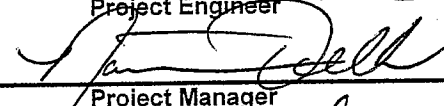

 Project Manager



 City Engineer

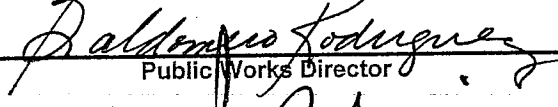

 Public Works Director

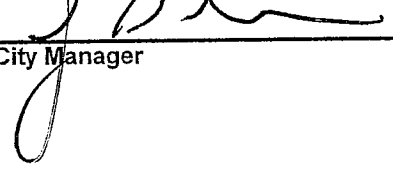

 City Manager

 Date 5/4/2012

 Date 5/9/2013

 Date 5/10/2013

 Date 5/13/2013

 Date 05/15/13